

GREENLAWNS HIGH SCHOOL
TERMINAL EXAMINATION 2021
TECHNICAL DRAWING APPLICATIONS

CLASS : X
TIME: 1.5HOURS

MARKS: 40 marks

Instructions:

1. Students must read the question carefully.
2. Write your name ON EACH SHEET
3. Click a picture and upload the images to classroom as a pdf.
4. Name your pdf as roll no.,name,std div e.g 15 Gunjan Bharwani 10A.
5. All construction lines must be shown

Q.1 Draw Elevation, Plan, LHSV and Development of a hexagonal prism (12)
of base side 30mm and axis height 65mm resting on its base on H.P.
with axis perpendicular to H.P. and parallel to the V.P. and one side of
the base inclined at 45° to the V.P.

Q.2 Refer Figure (1) Below: It shows two views of an object . Draw the (16)
Isometric View.

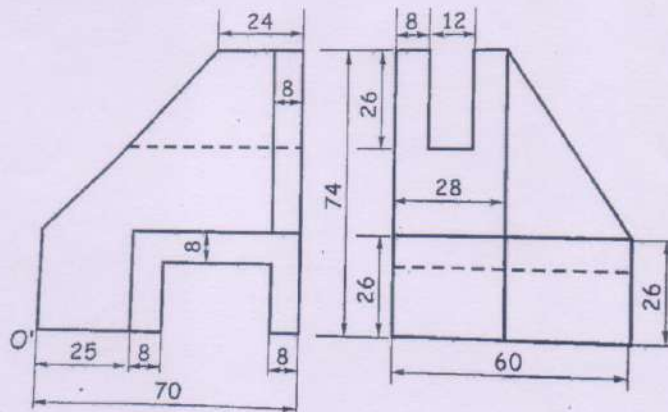

Figure(1)

Q3. In a drawing a line measuring 35 mm is marked as 10m. Find the R.F (12)
And construct a suitable scale long enough to measure upto 35m.
Using the above scale construct a Parabola of Base length 24m and
Axis height 18m using Rectangle method.